

1. Zadani zid

Student version

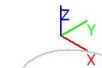
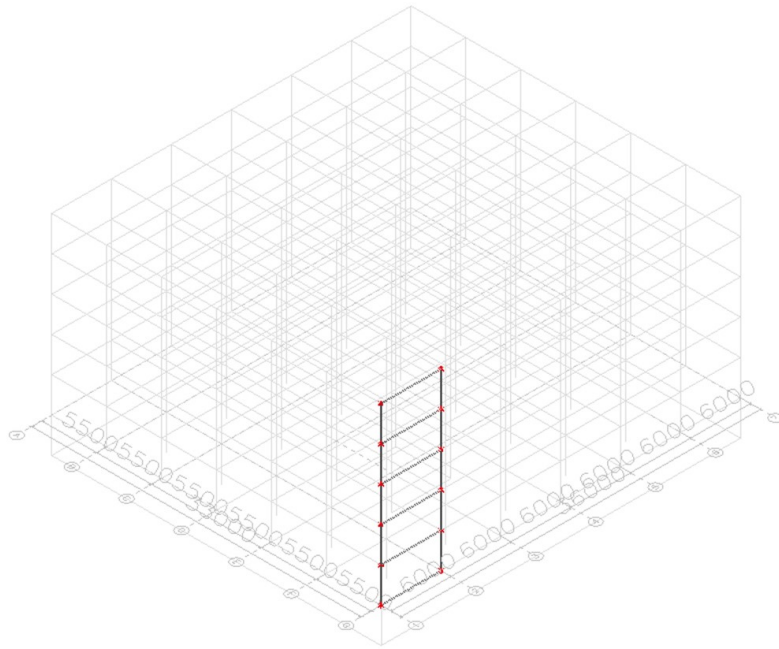

Student version

2. Zadani okvir

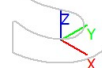
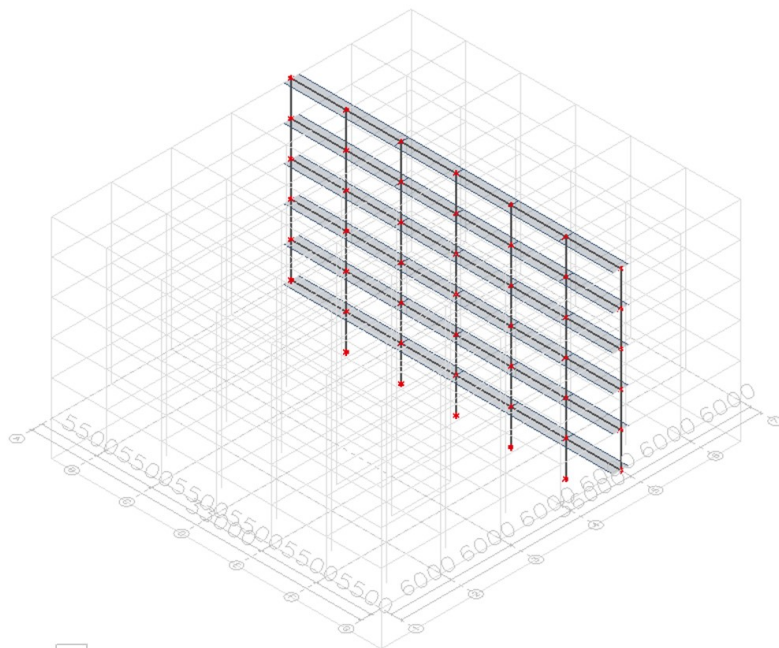

Student version

3. VT; M_y

Values: M_y

Linear calculation

Load case: LC1

Coordinate system: Principal

Extreme 1D: Member

Selection: All

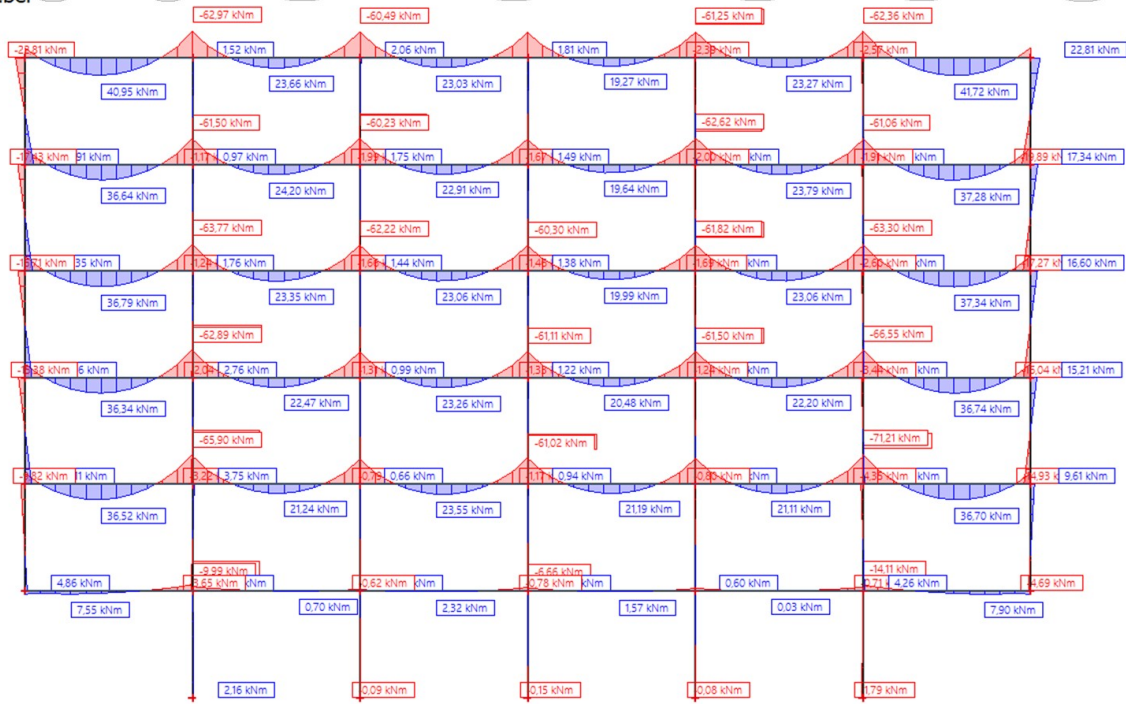

4. VT; V_z

Values: V_z

Linear calculation

Load case: LC1

Coordinate system: Principal

Extreme 1D: Member

Selection: All



5. VT; N

Values: N

Linear calculation

Load case: LC1

Coordinate system: Principal

Extreme 1D: Member

Selection: All

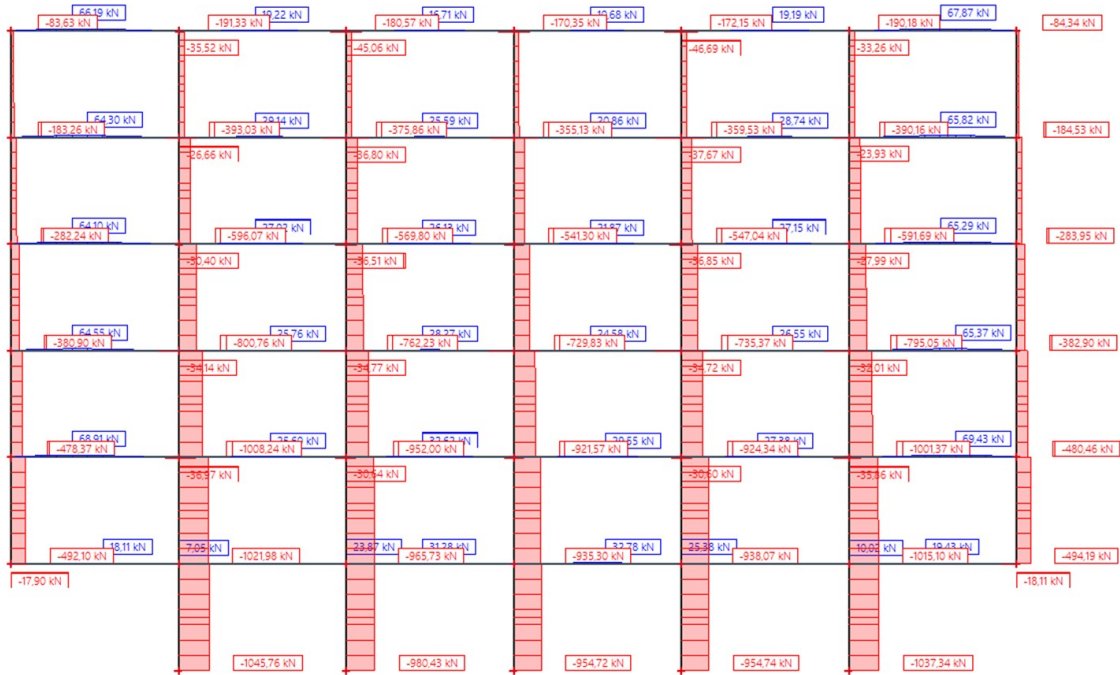

6. DS; M_y

Values: M_y

Linear calculation

Load case: DS

Coordinate system: Principal

Extreme 1D: Member

Selection: All

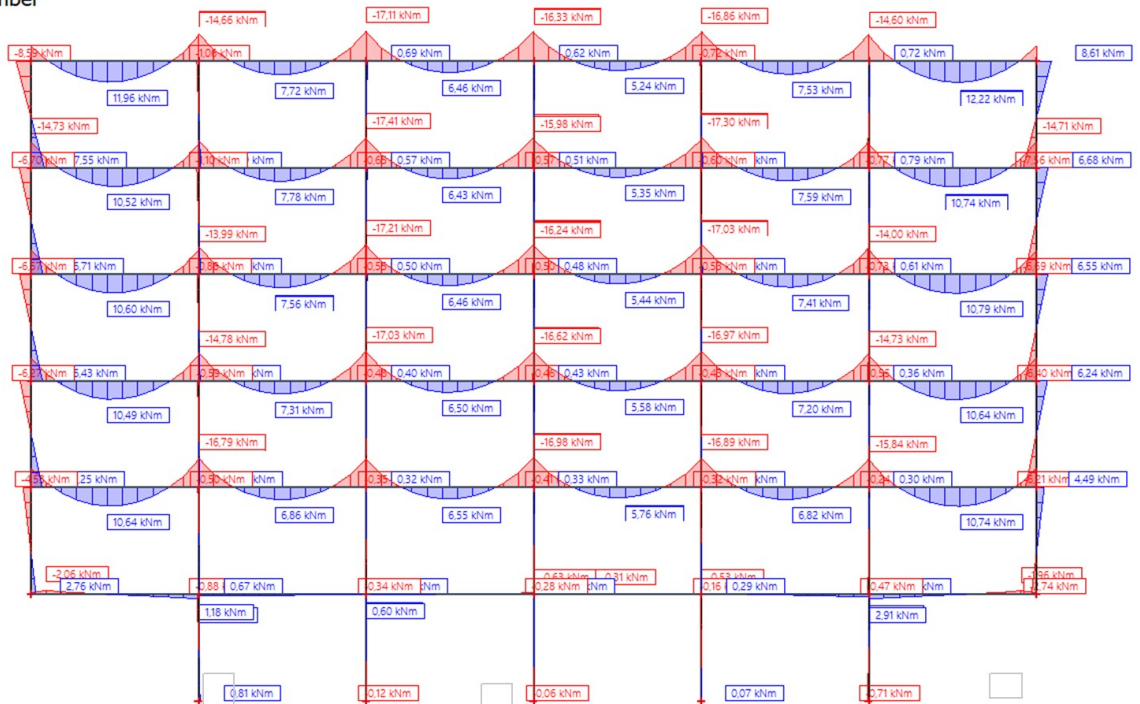

7. DS; V_z

Values: V_z

Linear calculation

Load case: DS

Coordinate system: Principal

Extreme 1D: Member

Selection: All

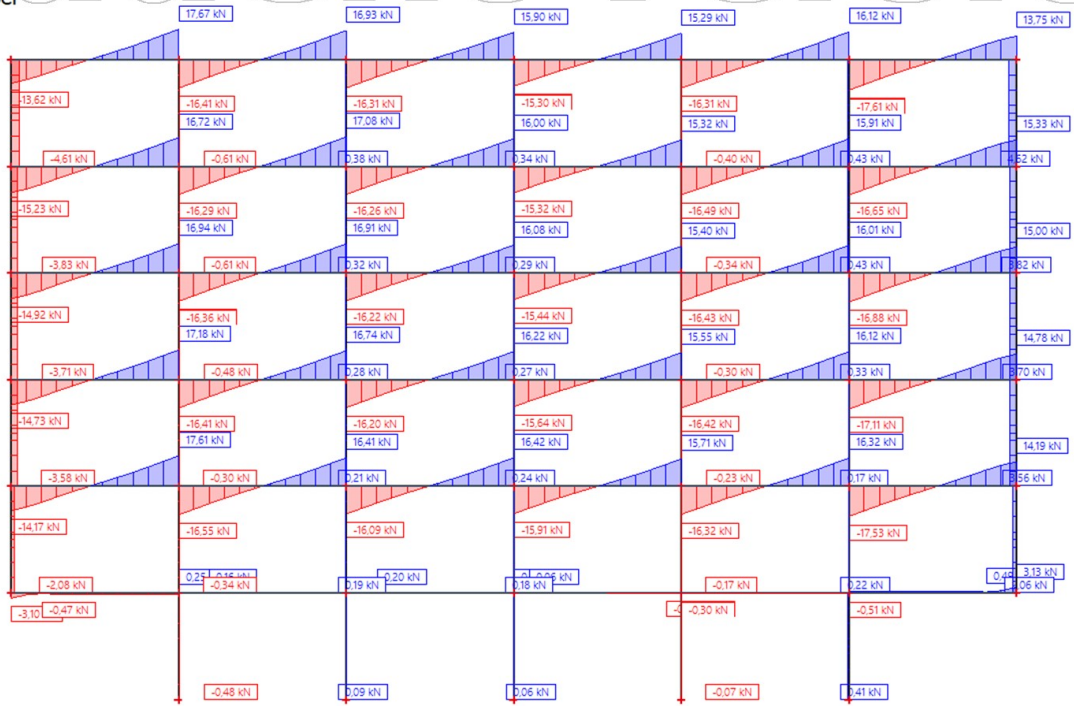

8. DS; N

Values: N

Linear calculation

Load case: DS

Coordinate system: Principal

Extreme 1D: Member

Selection: All

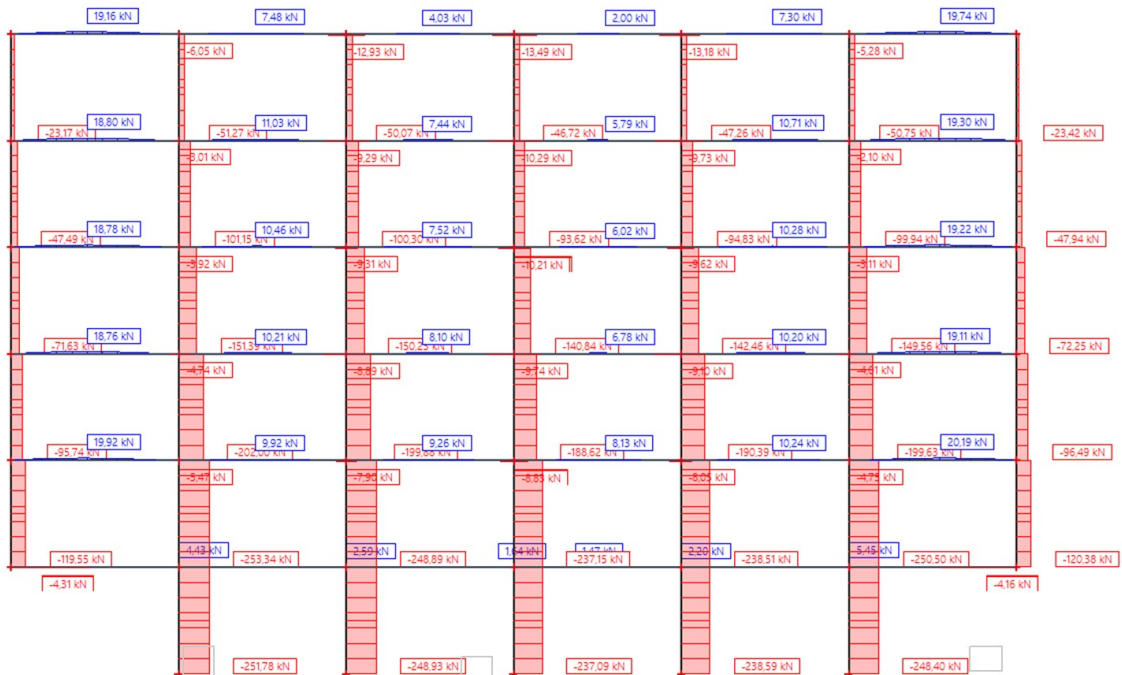

9. Q; M_y

Values: M_y

Linear calculation

Load case: Q

Coordinate system: Principal

Extreme 1D: Member

Selection: All



10. Q; V_z

Values: V_z

Linear calculation

Load case: Q

Coordinate system: Principal

Extreme 1D: Member

Selection: All



11. Q; N

Values: N
Linear calculation
Load case: Q
Coordinate system: Principal
Extreme 1D: Member
Selection: All

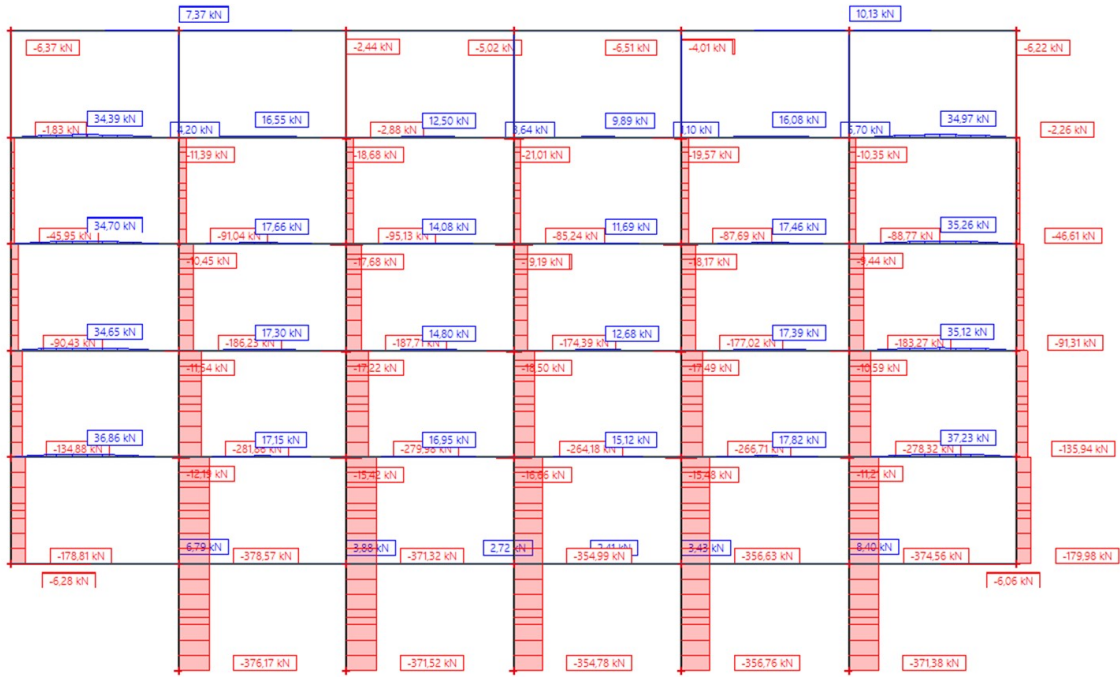

12. Q_KROV; M_y

Values: M_y
Linear calculation
Load case: Q_K
Coordinate system: Principal
Extreme 1D: Member
Selection: All



13. Q_KROV; V_z

Values: V_z
Linear calculation
Load case: Q_K
Coordinate system: Principal
Extreme 1D: Member
Selection: All

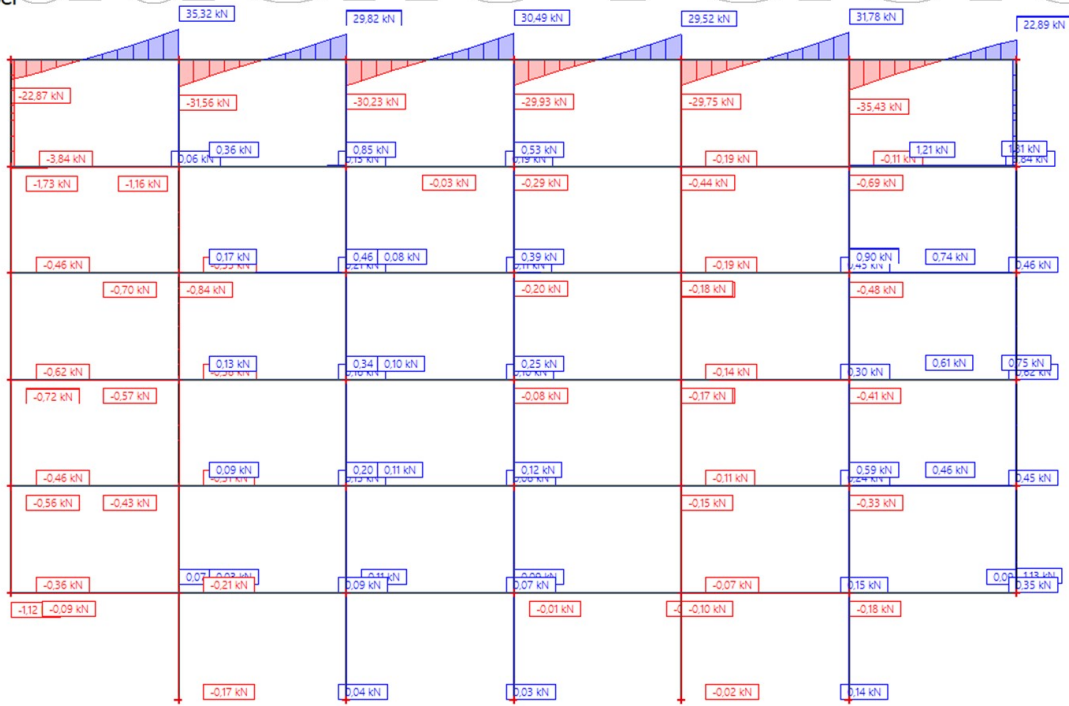

14. Q_KROV; N

Values: N
Linear calculation
Load case: Q_K
Coordinate system: Principal
Extreme 1D: Member
Selection: All

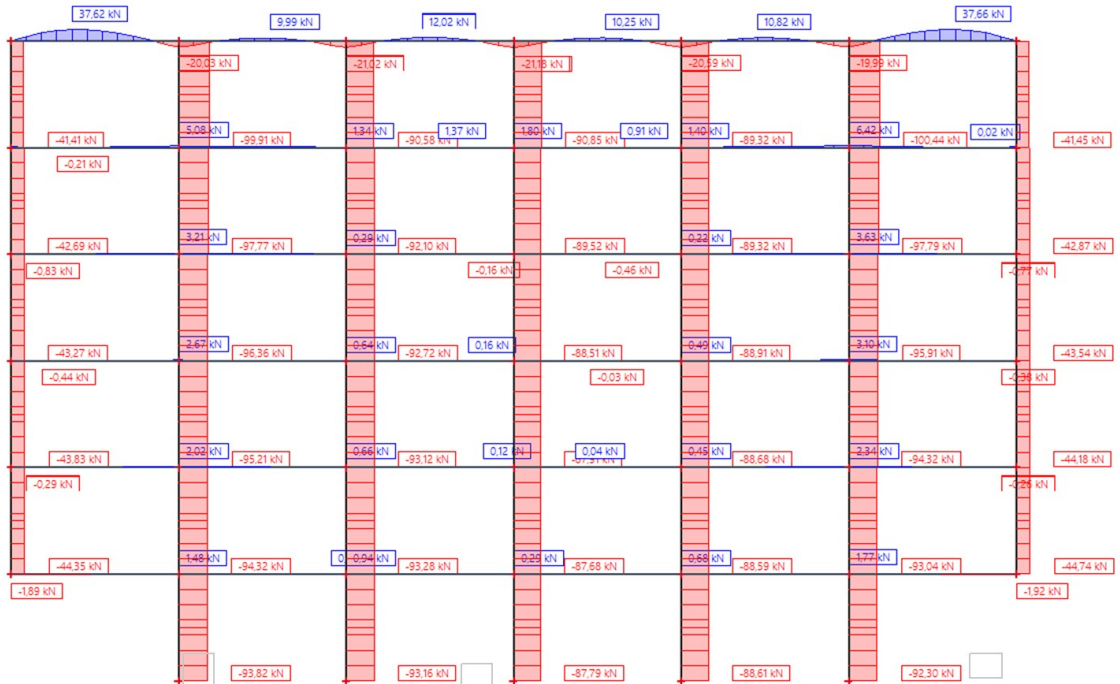

15. S_X; M_y

Values: M_y
Linear calculation
Load case: S_X
Coordinate system: Principal
Extreme 1D: Member
Selection: All

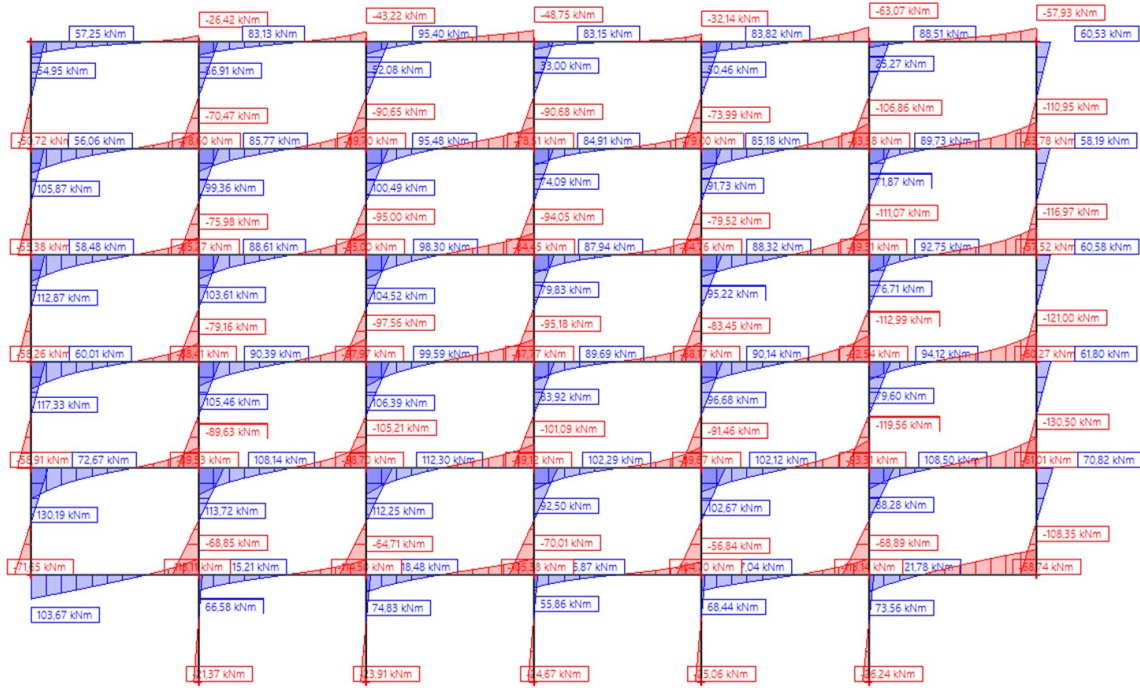

16. S_X; V_z

Values: V_z
Linear calculation
Load case: S_X
Coordinate system: Principal
Extreme 1D: Member
Selection: All

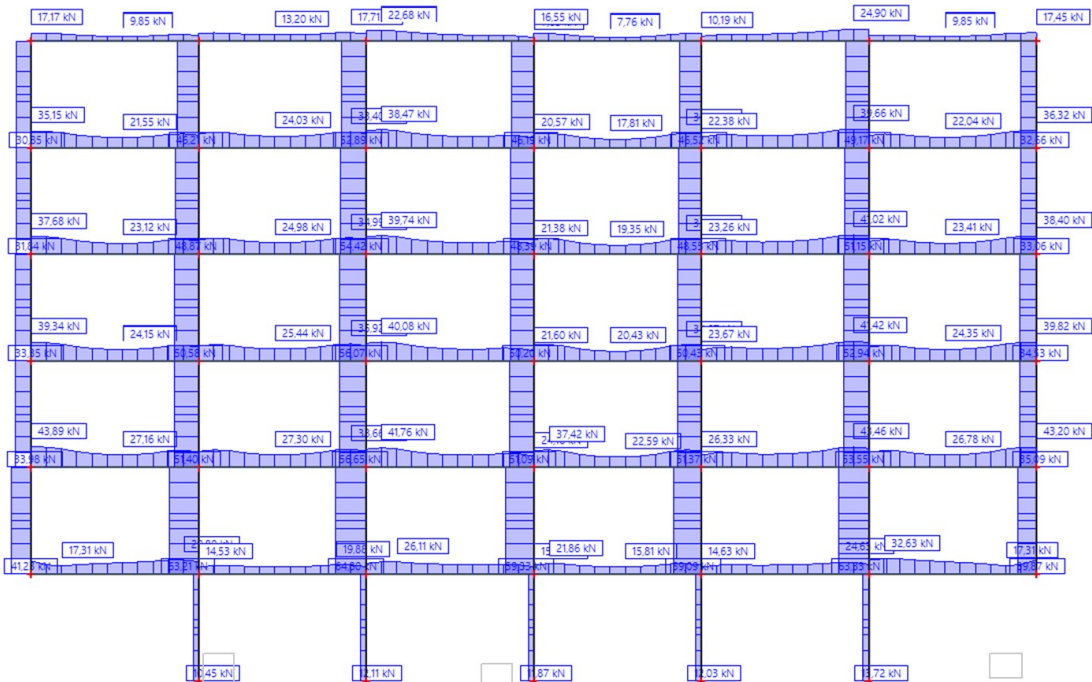

17. S_X; N

Values: N

Linear calculation

Load case: S_X

Coordinate system: Principal

Extreme 1D: Member

Selection: All

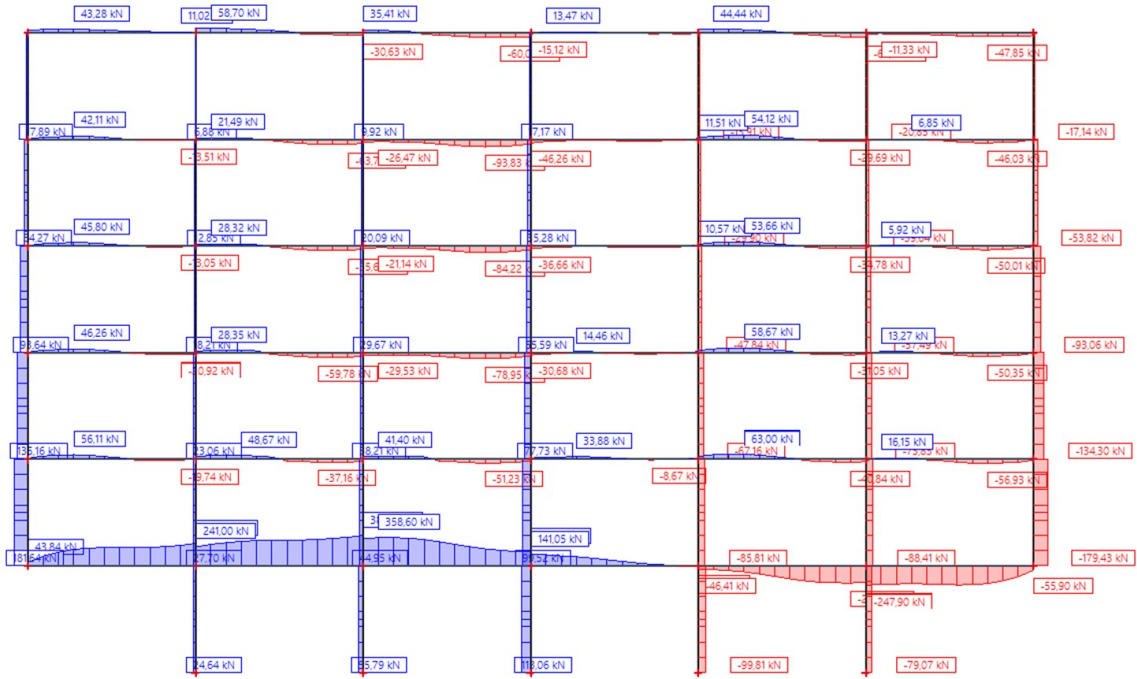

18. S_X_torzija; M_y

Values: M_y

Linear calculation

Load case: S_X_AE

Coordinate system: Principal

Extreme 1D: Member

Selection: All

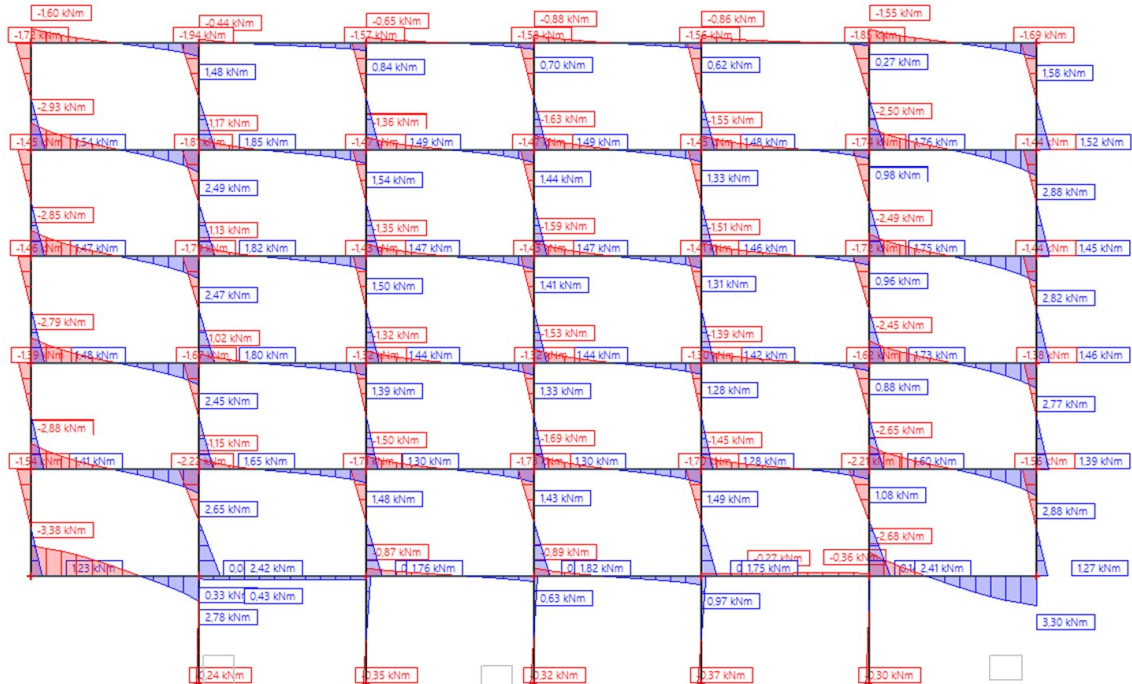

19. S_X_torzija; V_z

Values: V_z

Linear calculation

Load case: S_X_AE

Coordinate system: Principal

Extreme 1D: Member

Selection: All



20. S_X_torzija; N

Values: N

Linear calculation

Load case: S_X_AE

Coordinate system: Principal

Extreme 1D: Member

Selection: All

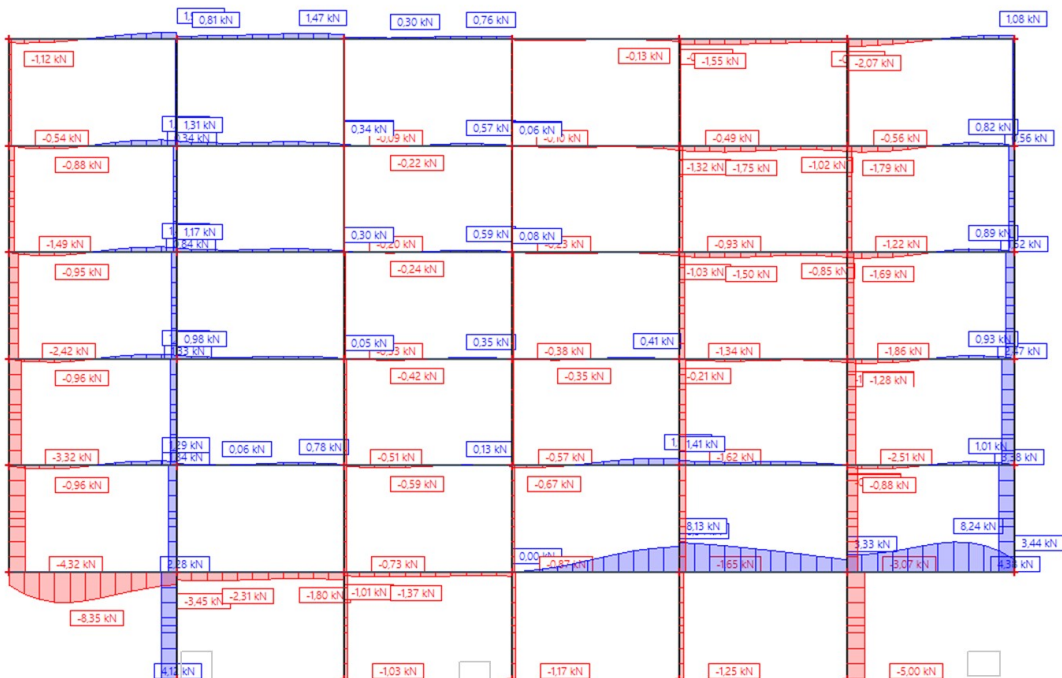

21. S_Y; M_y

Values: M_y

Linear calculation

Load case: S_Y

Coordinate system: Principal

Extreme 1D: Member

Selection: All

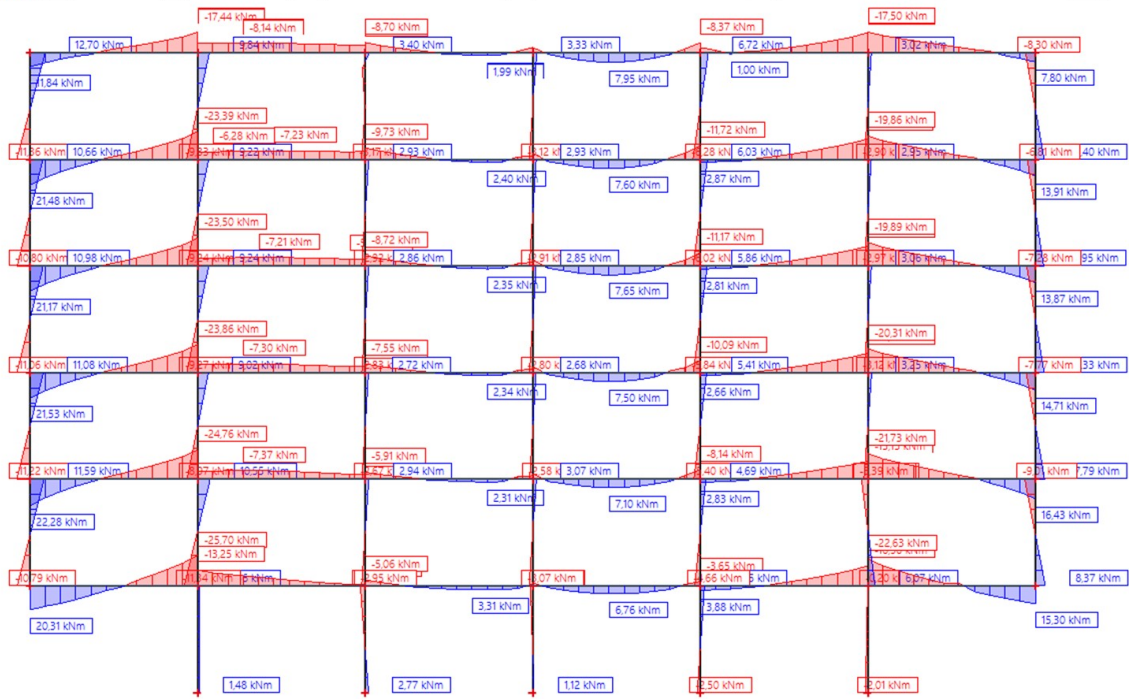

22. S_Y; V_z

Values: V_z

Linear calculation

Load case: S_Y

Coordinate system: Principal

Extreme 1D: Member

Selection: All

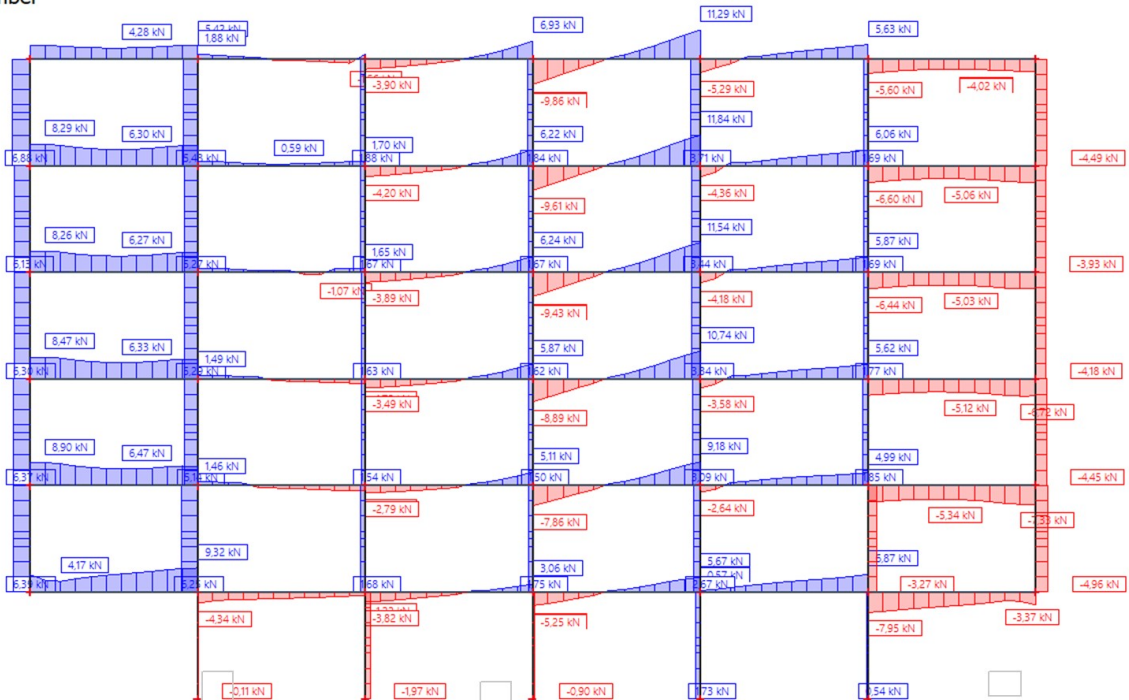

23. S_Y; N

Values: N
Linear calculation
Load case: S_Y
Coordinate system: Principal
Extreme 1D: Member
Selection: All

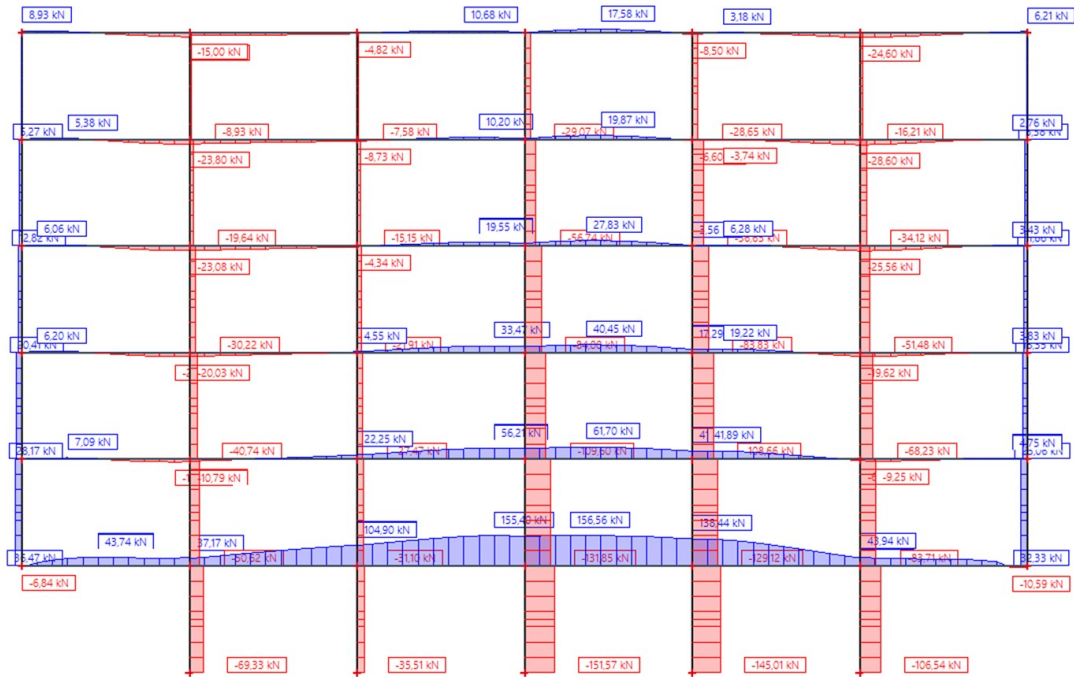

24. S_Y torzija; M_y

Values: M_y
Linear calculation
Load case: S_Y_AE
Coordinate system: Principal
Extreme 1D: Member
Selection: All



25. S_Y_torzija; V_z

Values: V_z

Linear calculation

Load case: S_Y_AE

Coordinate system: Principal

Extreme 1D: Member

Selection: All



26. S_Y_torzija; N

Values: N

Linear calculation

Load case: S_Y_AE

Coordinate system: Principal

Extreme 1D: Member

Selection: All

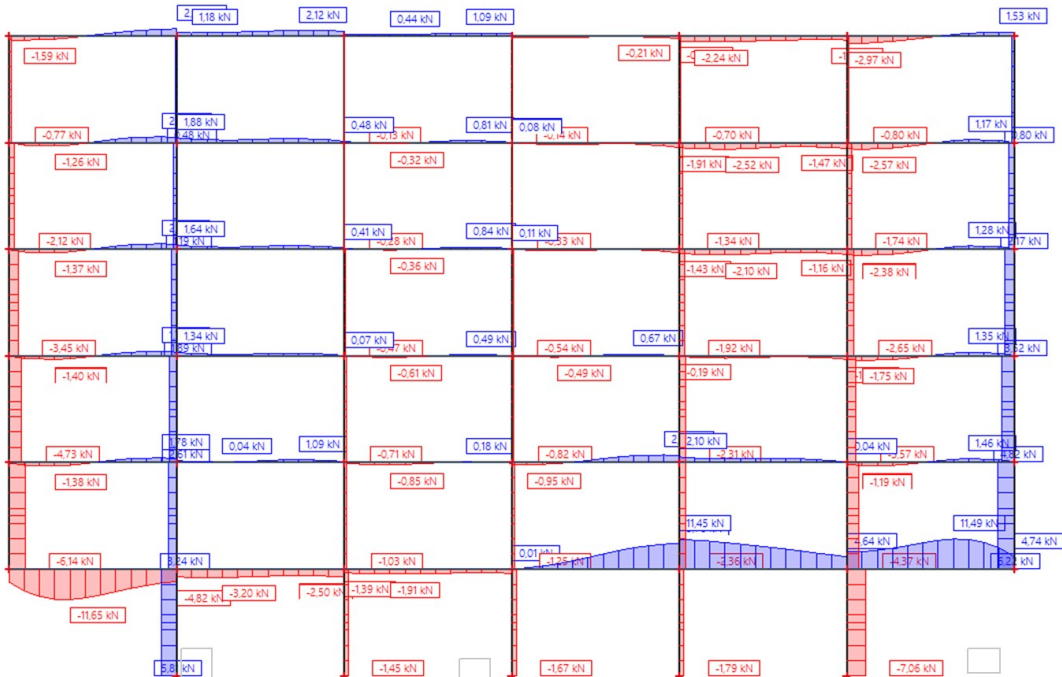

27. VT; F_X

Student version

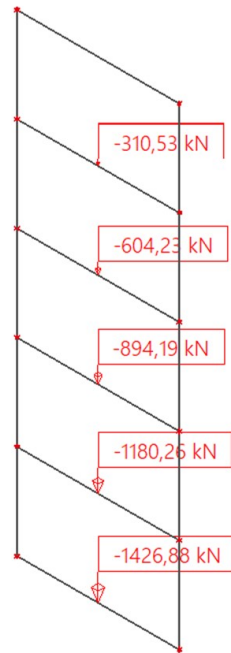

28. VT; F_Y

Student version

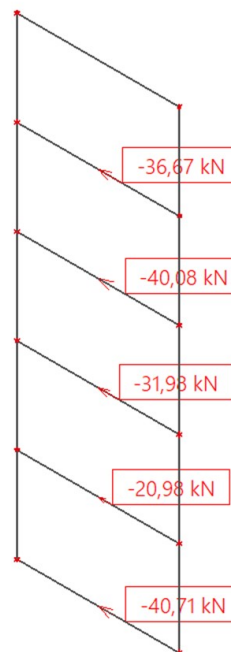

Student version

29. VT; M_Y

Student version

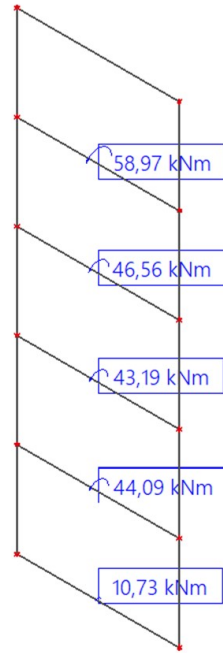

30. VT; M_Z

Student version

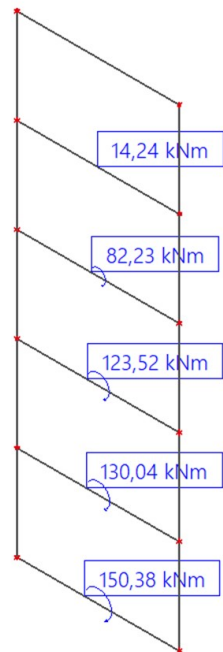

Student version

31. DS; F_X

Student version

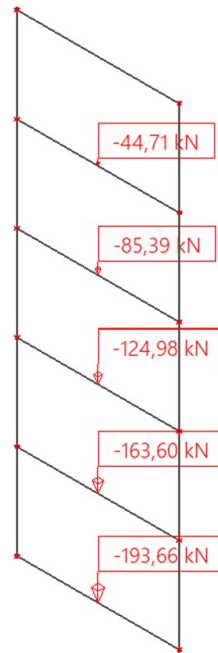

32. DS; F_Y

Student version

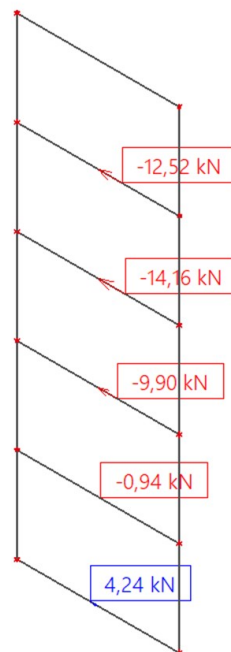

Student version

33. DS; M_Y

Student version

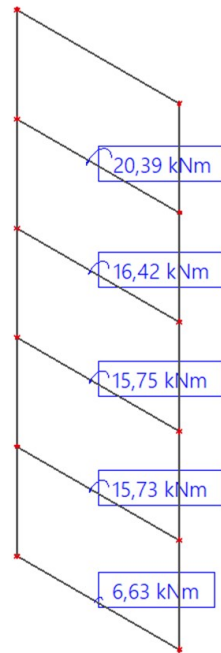

34. DS; M_Z

Student version

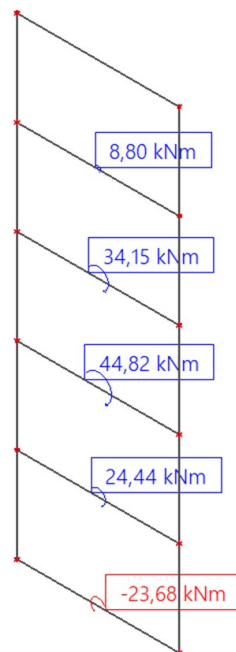

Student version

35. Q; F_X

Student version

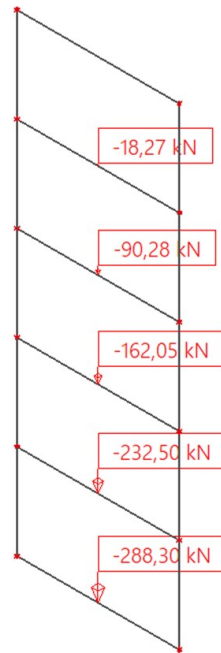

36. Q; F_Y

Student version

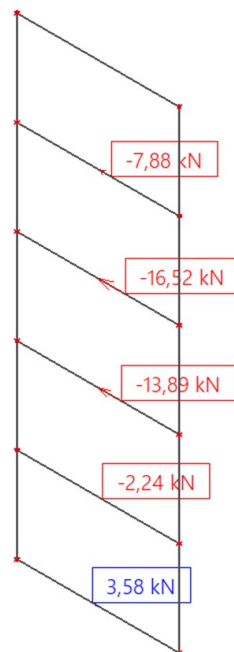

Student version

37. Q; M_Y

Student version

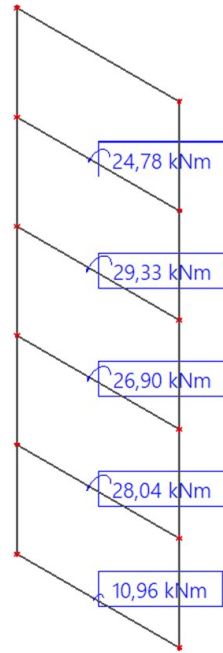

38. Q; M_Z

Student version

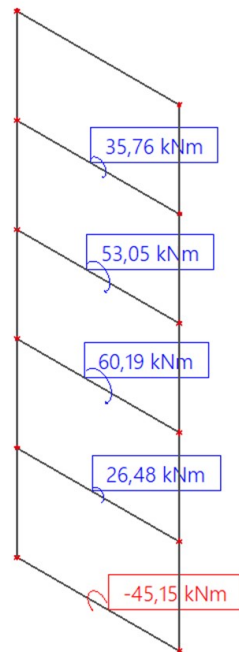

Student version

39. Q krov; F_X

Student version

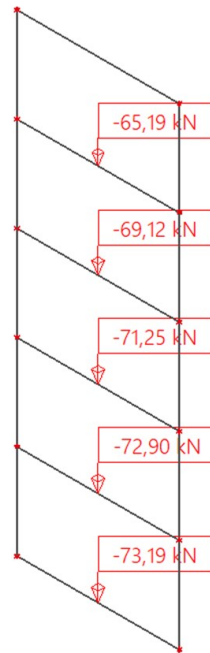

40. Q krov; F_Y

Student version

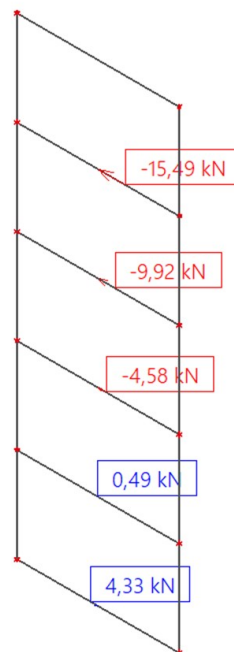

Student version

41. Q krov; M_Y

Student version

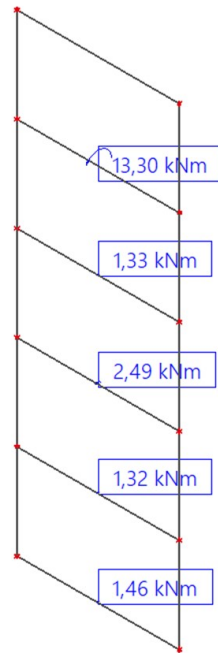

42. Q krov; M_Z

Student version

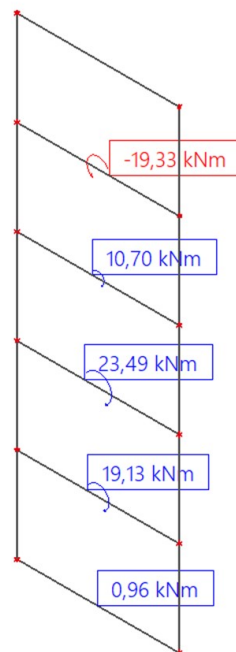

Student version

43. S_X; F_X

Student version

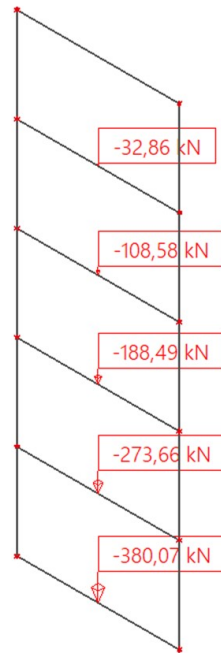

44. S_X; F_Y

Student version

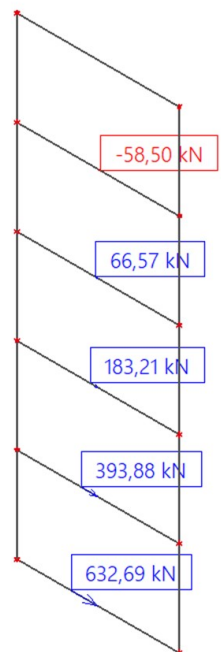

Student version

45. S_X; M_Y

Student version

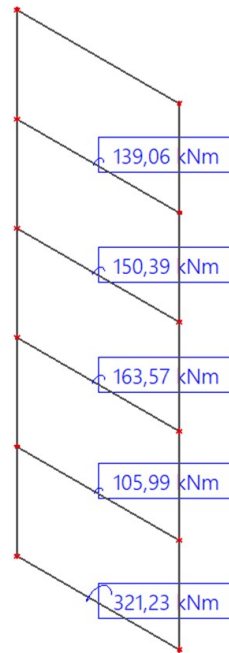

46. S_X; M_Z

Student version

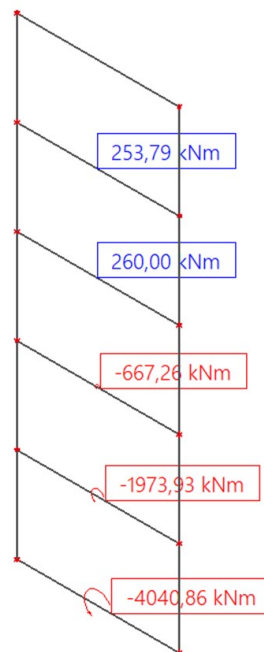

Student version

47. S_X torzija; F_X

Student version

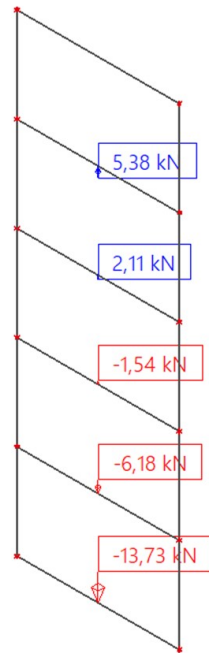

48. S_X torzija; F_Y

Student version

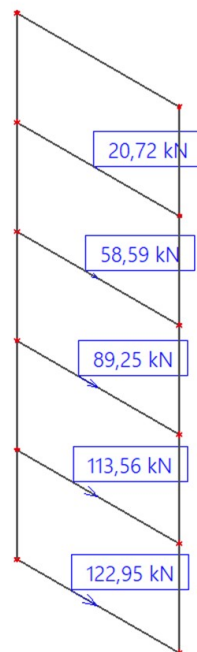

Student version

49. S_X torzija; M_Y

Student version

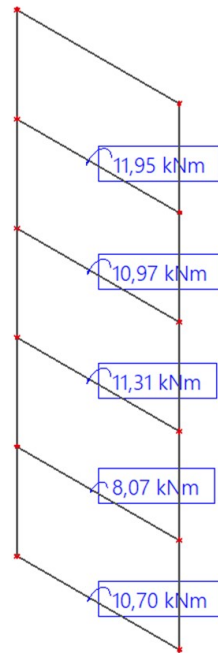

50. S_X torzija; M_Z

Student version

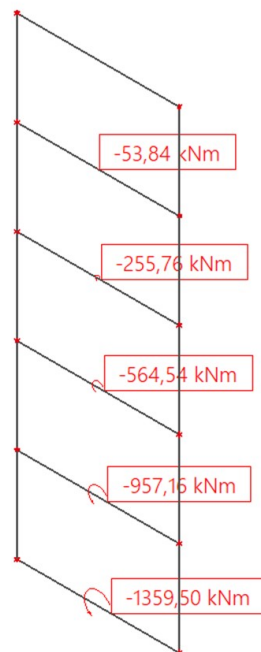

Student version

51. S_Y; F_X

Student version

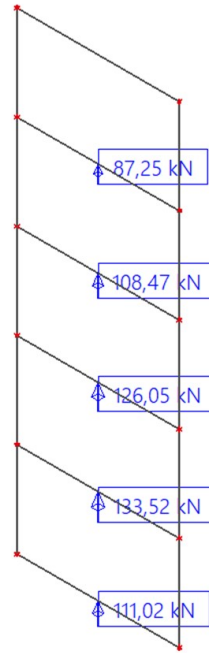

52. S_Y; F_Y

Student version

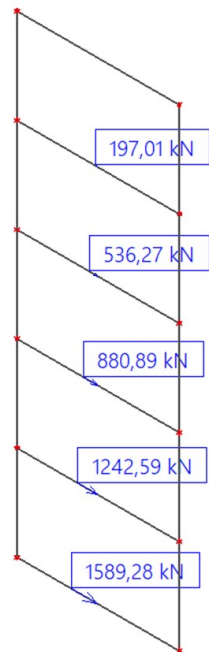

Student version

53. S_Y; M_Y

Student version

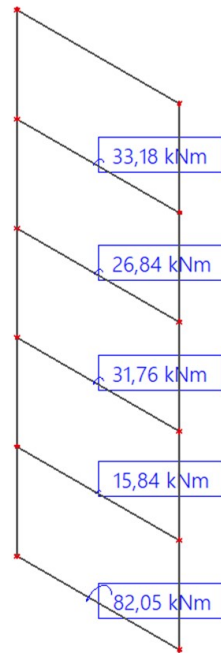

54. S_Y; M_Z

Student version

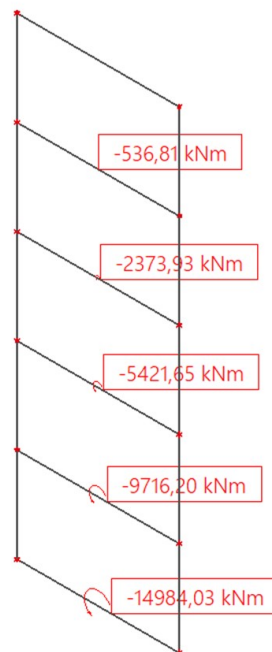

Student version

55. S_Y torzija; F_X

Student version

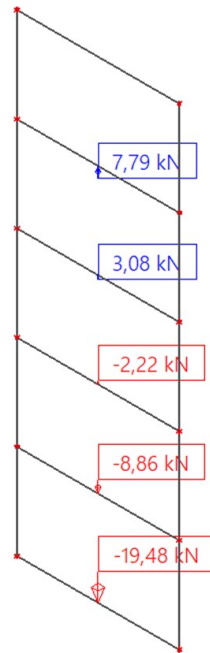

56. S_Y torzija; F_Y

Student version

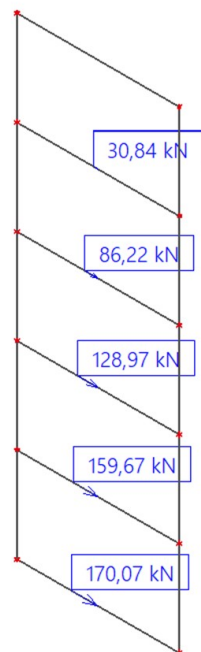

Student version

57. S_Y torzija; M_Y

Student version

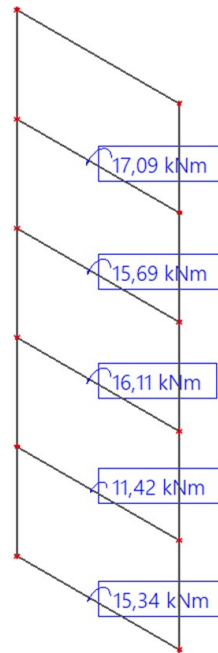

58. S_Y torzija; M_Z

Student version

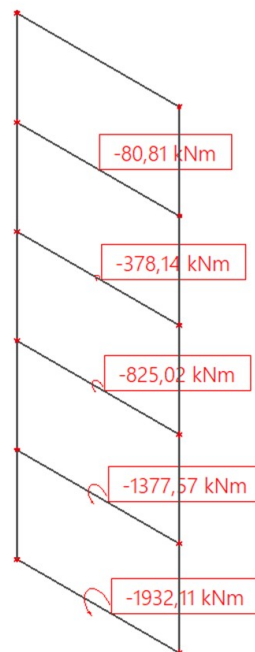

Student version